

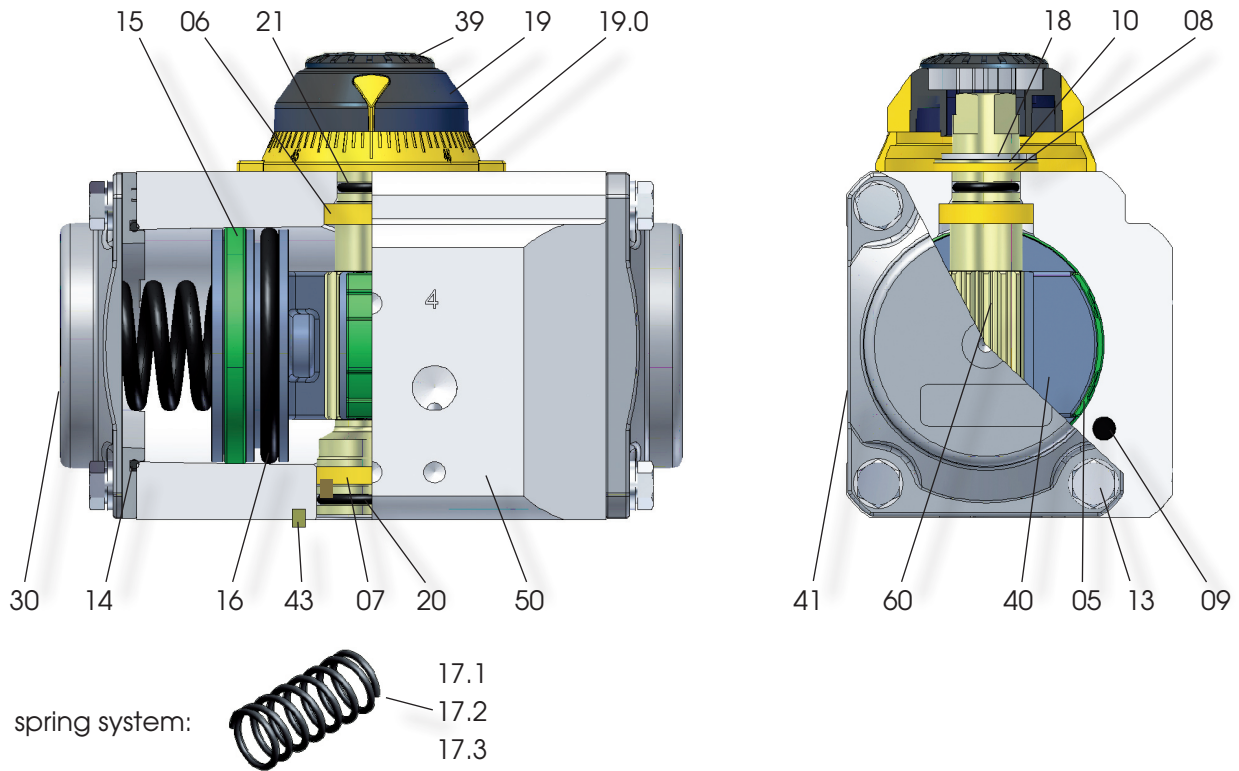

The EDITION 2010
Part Description
DR/SC00010U



AIR TORQUE
PNEUMATISCHE STELLANTRIEBE



PART N°	Spare parts	UNIT Q.TY / NOTE	PART DESCRIPTION	STANDARD MATERIAL (A) (B)
05	○	2	BEARING (Piston back)	PA46
06	○	1	BEARING (Pinion top)	PA46
07	○	1	BEARING (Pinion bottom)	PA46
08	○	1	THRUST BEARING (Pinion)	PA46
09	○ ⊕	2	PLUG	Silicone
10		1	THRUST WASHER (Pinion)	Stainless Steel
13		8	CAP SCREW (End cap)	Stainless Steel
14	○ ⊕	2	"O" RING (End cap)	M-NBR
15	○	2	BEARING (Piston head)	POM
16	○ ⊕	2	"O" RING (Piston)	M-NBR
17.1			SPRING	
17.2		max. 2	SPRING	Si Cr Spring alloy Steel expoy coated
17.3			SPRING	
18		1	SPRING CLIP (Pinion)	Spring Steel, ENP
19		1	POSITION INDICATOR	PA66+GF+CB
19.0		1	GRADUATED RING	PA66+GF(+CB)
20	○ ⊕	1	"O" RING (Pinion bottom)	M-NBR
21	○ ⊕	1	"O" RING (Pinion top)	M-NBR
30		2	END CAP	Pressure Die Cast Aluminium alloy, anodized and coated
39		1	CAP SCREW (Indicator)	PA66+GF+CB
40		2	PISTON	Pressure Die Cast Aluminium alloy, anodized
41		1	ACTUATOR IDENTIFICATION LABEL	Polyester-Silver
42		2	END CAP LABEL	Polyester-Silver
43		1	SPIGOT (Only on request)	Extruded Aluminium alloy, anodized
50		1	BODY	Extruded Aluminium alloy, coated
60		1	DRIVE SHAFT	Extruded Alluminium alloy, anodized
60.1		1 only f prot. level E and EC	INTEGRAL DRIVE SHAFT	Stainless Steel, ENP

○ Parts included in Complete spare parts kit ⊕ Parts included in „O” ring spare parts kit